

# Biiicam

BO-01

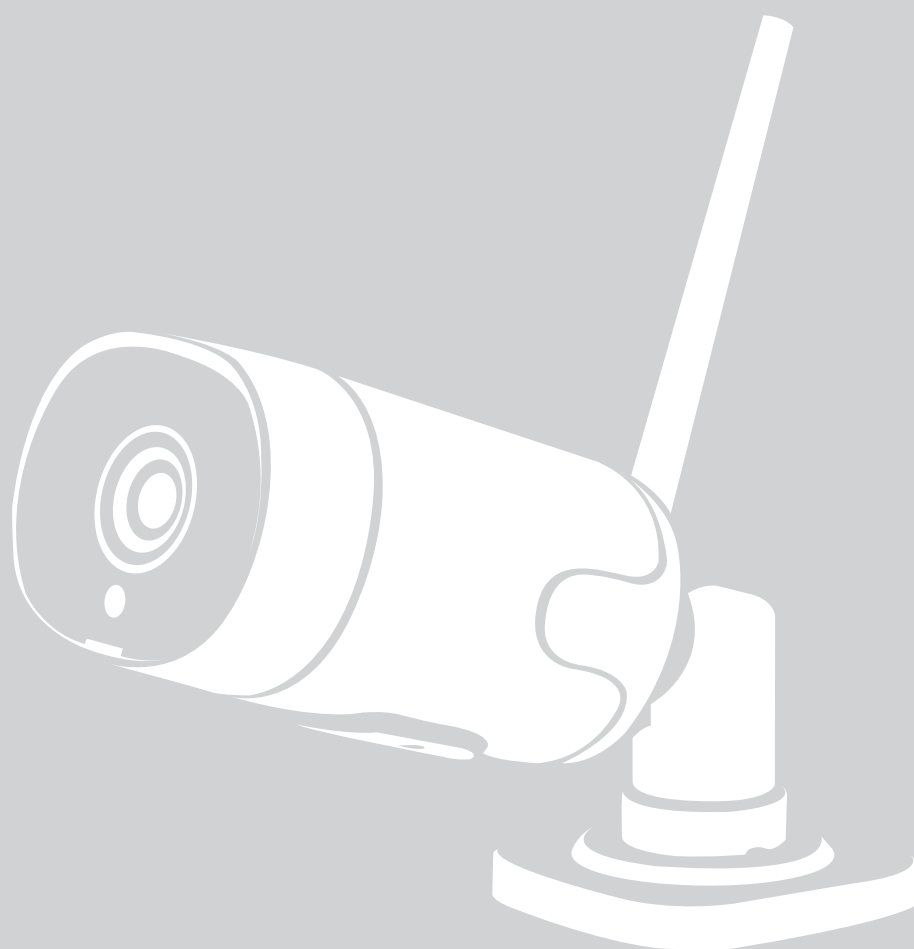

User manual for outdoor IP camera



# INDEX

## A. INTRODUCTION OF Biicam-B0-01

3

## B. PRODUCT OVERVIEW

3

B1. PRODUCT OVERVIEW

3

B2. KIT CONTENTS

4

B3. SPECIFICATIONS

4

## C. INSTALLATION GUIDE

5

C1. HARDWARE INSTALLATION

5

## D. Eyeopen SETUP GUIDE

6

D1. APPLY FOR A NEW ACCOUNT

6

D2. CONNECT Biicam TO Eyeopen

7-9

D3. OWNER SHARES THE Biicam TO OTHER USERS

10

D4. PUSH NOTIFICATION

11

## E. FAQ

12

E1. FAQ

12

## A. INTRODUCTION OF BO-01

BO-01 is a device which can be integrated with Eyeopen App and Eyeopen 's devices.  
BO-01 will provide a live view of the site which allows you to check the environment before operation. With a micro SD card,  
BO-01 can record each operation and movement for future review.

## B. PRODUCT OVERVIEW

### B1.PRODUCT OVERVIEW

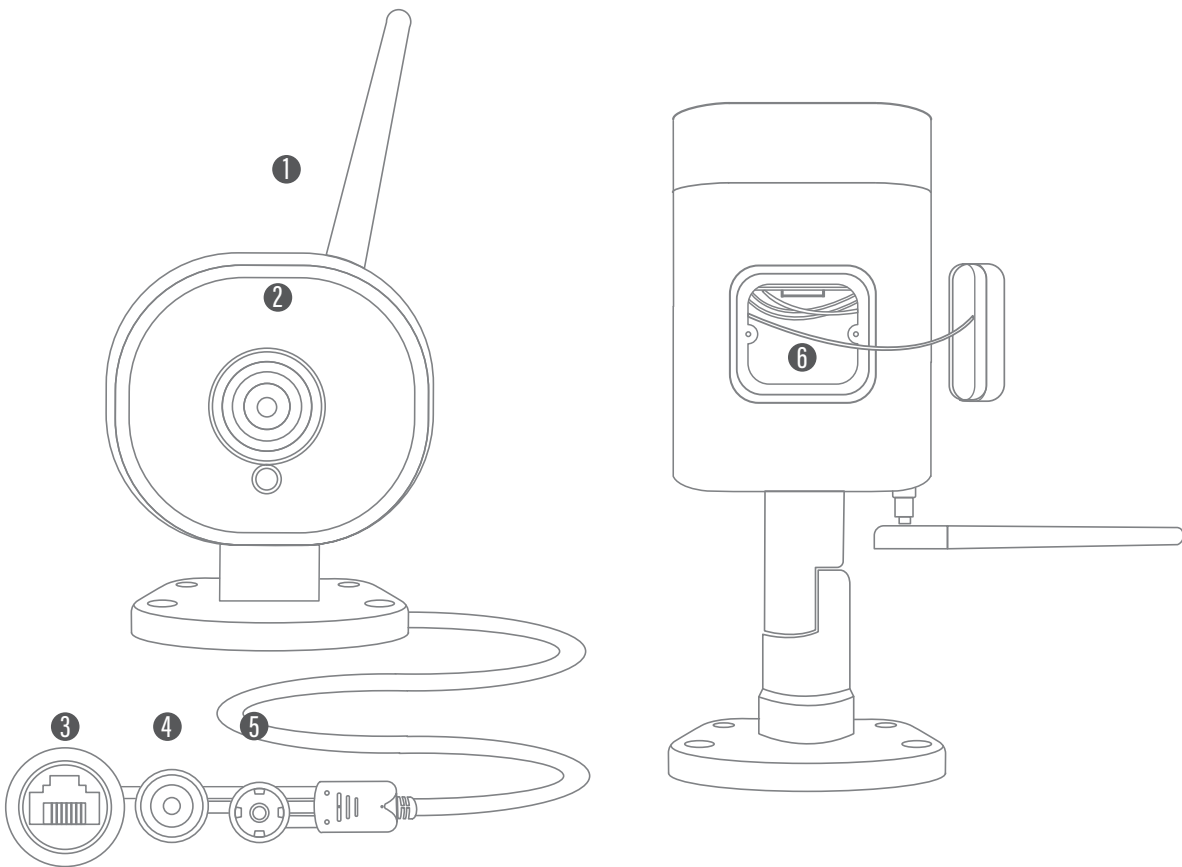

- 1 Antenna
- 2 IP camera

- 3 RJ45 cable terminal
- 4 Reset button

- 5 Power plug terminal
- 6 Micro SD card slot

### **!** WARNING SAFETY INSTRUCTIONS

*Please read this manual carefully before installation. Powertech Automation Inc.is not responsible For improper installation and Failure to comply with local electrical and building regulations. Please keep all the components of the BiiCAM and this manual for further consultation.*

## B2. KIT CONTENTS

### ▶ BO-01 ◀

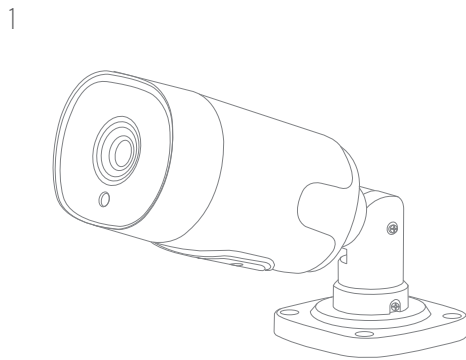

### ▶ HARDWARE ◀

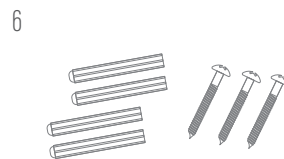
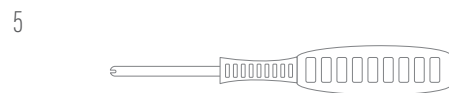
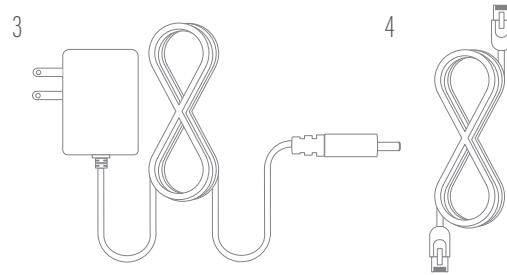

REF.	DESIGNATION	AMOUNT
1.	BO-01	1
2.	Antenna	1
3.	Power plug	1
4.	LAN cable	1
5.	Screwdriver	1
6.	Anchors with screws kit	1
7.	Cable gland	1

## B3. SPECIFICATIONS

BO-01			
Video resolution	Full HD 1080P	Alarm	Motion Detection
Compression	H.264	Storage	Micro SD Card 128GB (SD Card Not Include)
Frame rate	1920x1080@15fps	Record mode	Event
Field of view	100°	Waterproof Rating	IP66
Day/night mode	ICR with IR LED	Operating temperature	-10°C - 40°C
Connectivity	802.11b/g/n@2.4GHz	Power	Power Adapter DC 12V/1A
Ethernet	10/100Mbps		

## C. INSTALLATION GUIDE

### C1. HARDWARE INSTALLATION

1. Connect the antenna to the B0-01.
2. Connect the power plug to the B0-01.
3. Connect the power plug to a power outlet.

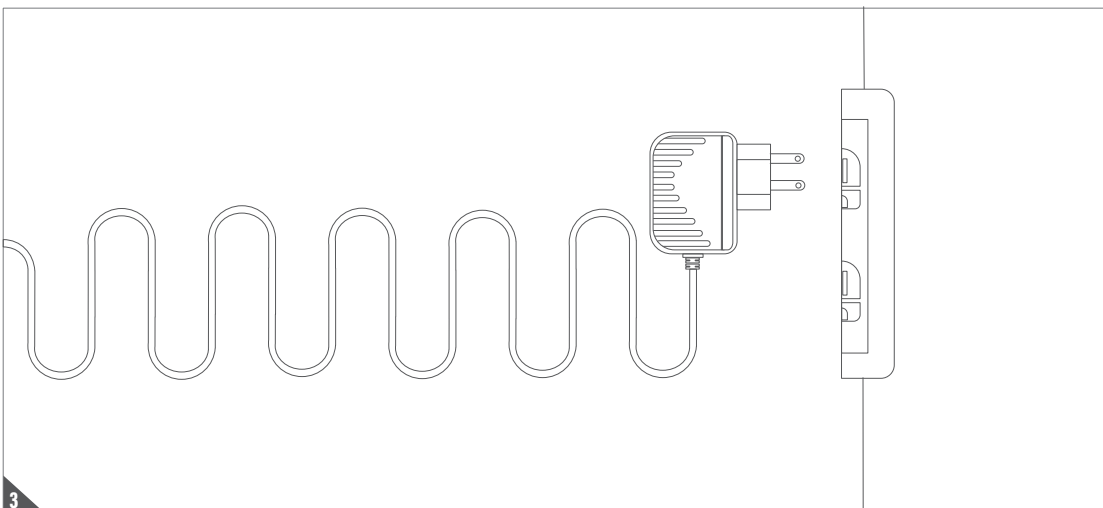
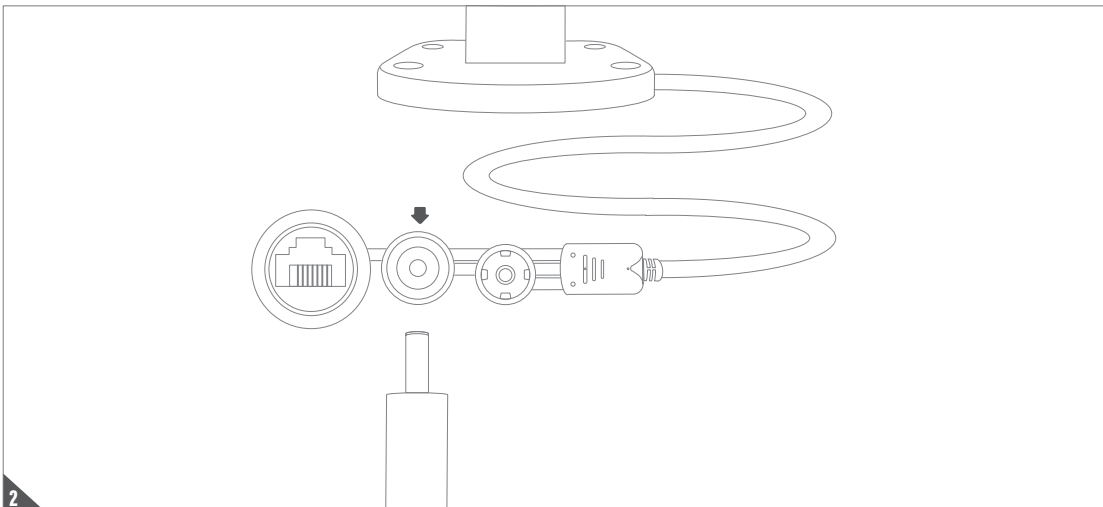
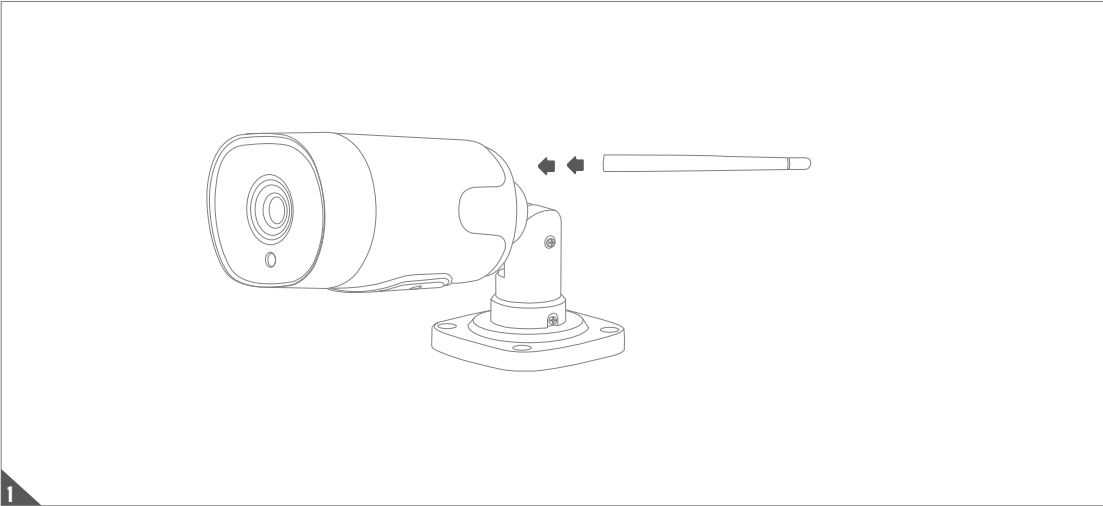

B0-01

# D. Eyeopen SETUP GUIDE

## D1. APPLY FOR A NEW ACCOUNT

1. Please scan the QR code and download Eyeopen.
2. Press sign up icon and press the agree icon to continue.
3. Please type the following information for registration:



- a. Password (enter twice for verification)
- b. The password should have at least 1 English character and at least 8 characters/numbers in total.

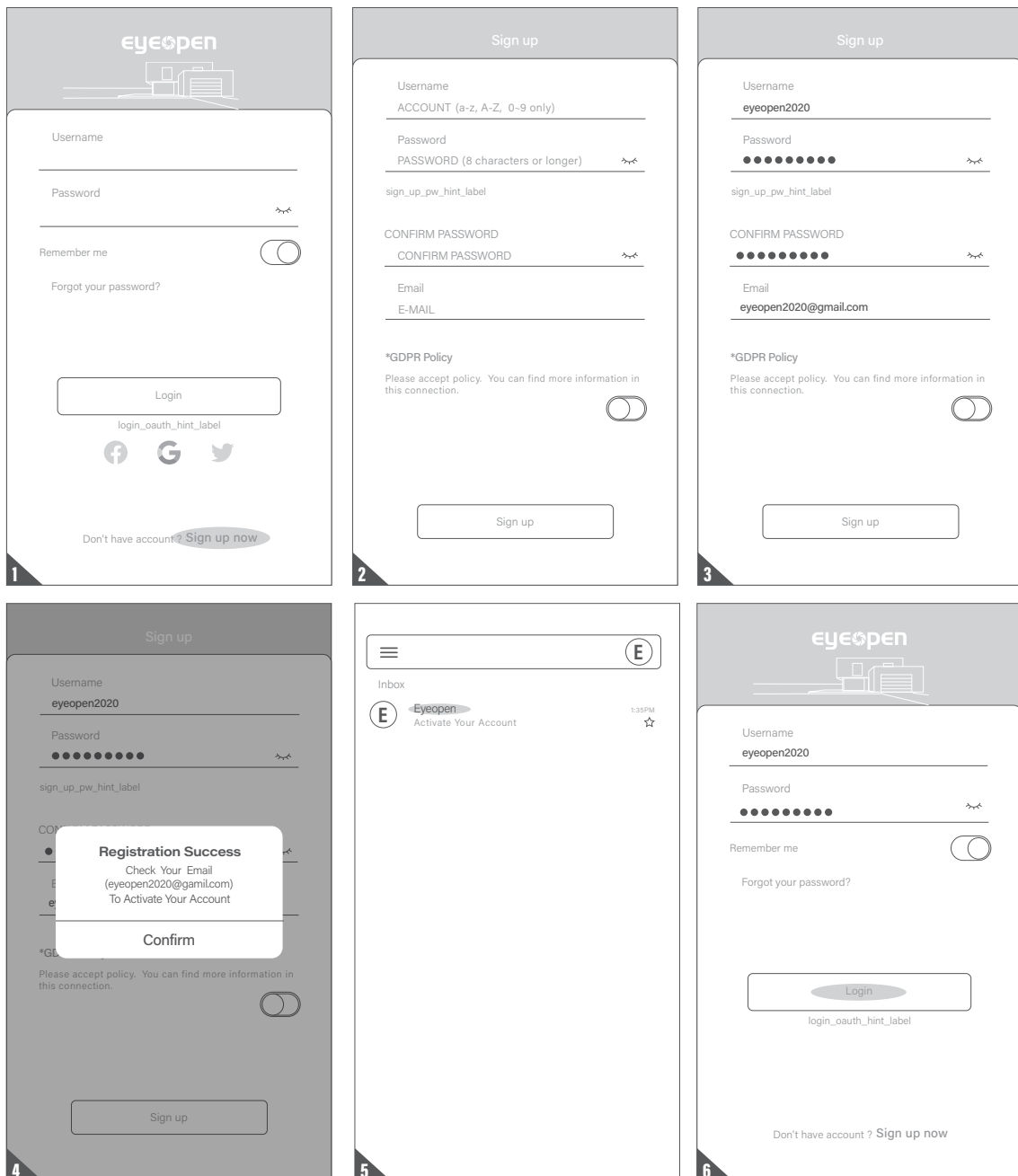

4. The system will send a link to your email when the registration succeeds.
5. Please go to your email, and click the link to activate your account.
6. Please log in to your account.

## D2. CONNECT Biicam TO Eyeopen

**!** Make sure the Biicam is perfectly installed and powered.

### ● ADD NEW Biicam

1. Tap(+) icon to add a new device.
2. Tap BO-01.
3. Choose QR code scanning.

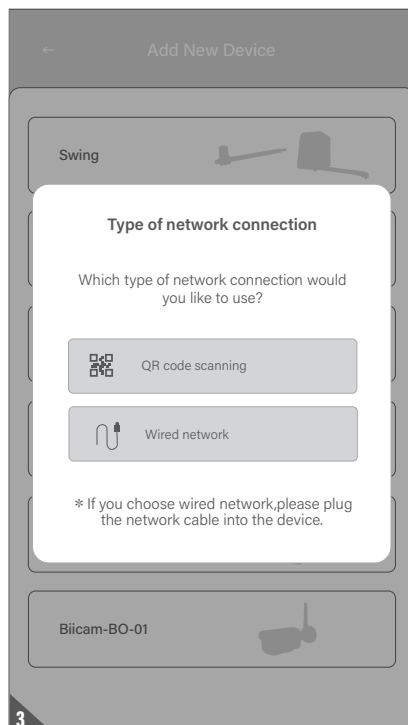
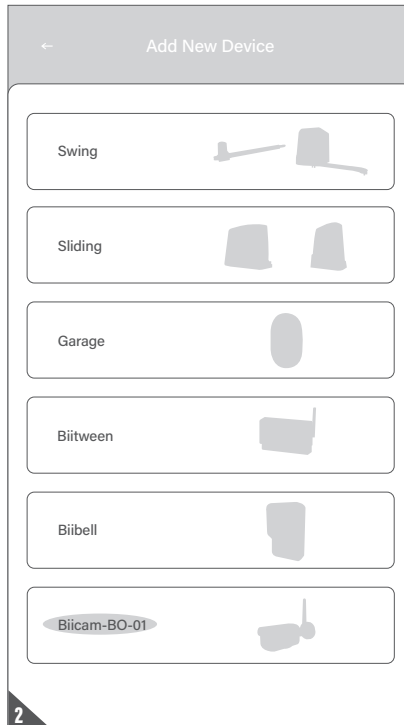
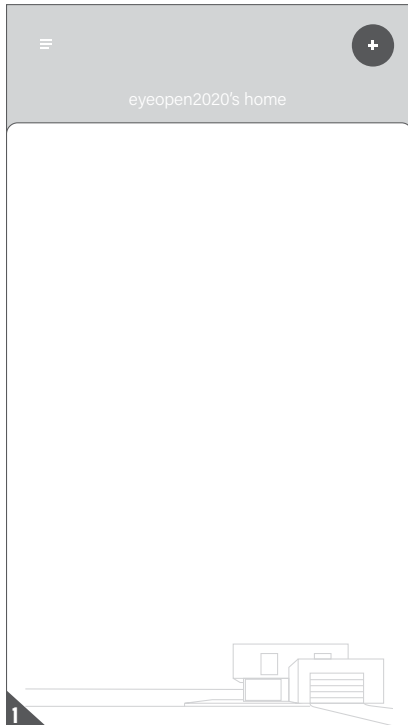



## ● Connect the BO-01 to Wi-Fi

1. Follow the indication to reset BO-01.
2. Enter the Wi-Fi password and press **"Next"** to create a QR code.
3. Scan the QR code with the BiICAM. Once BiICAM scanned the QR code,, it will beep once, then press "I hear a Prompt".
4. System will start to connect to Wi-Fi.
5. Name the device.
6. Once the setup is complete, BO-01 will show on the main page.

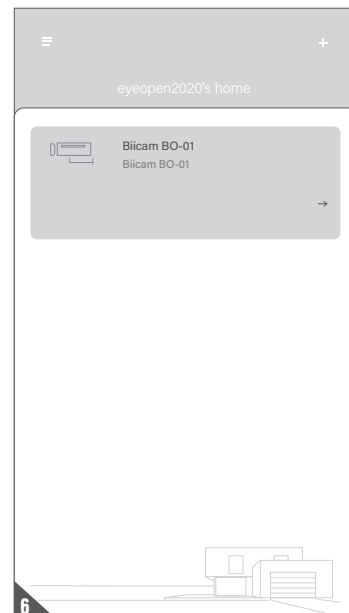
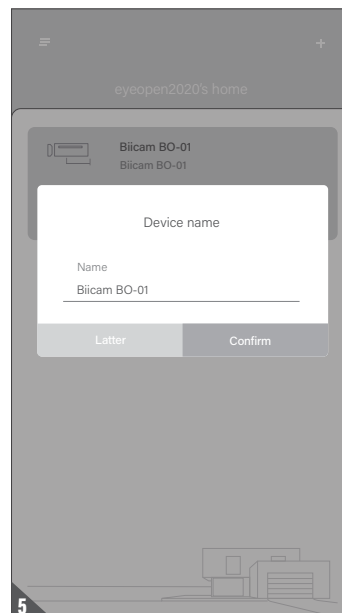
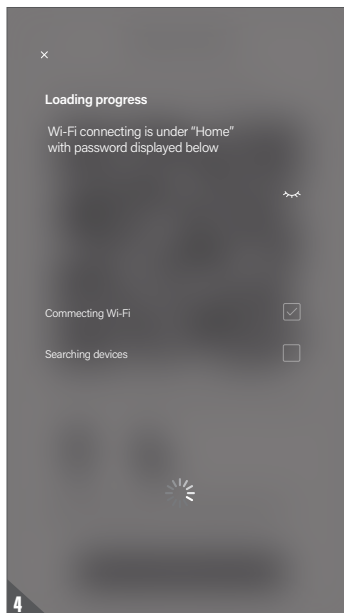
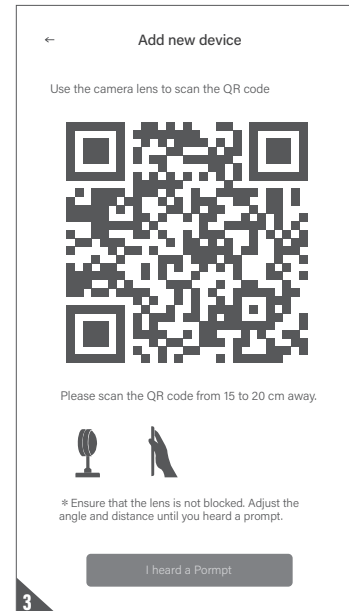
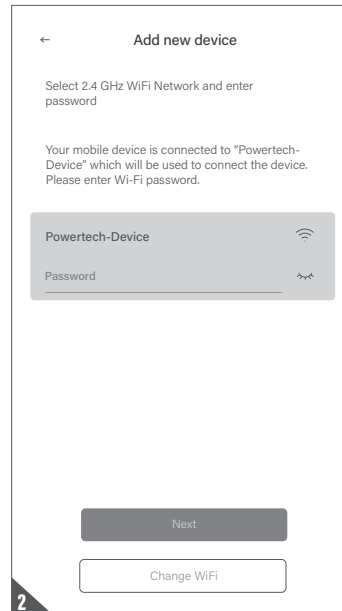
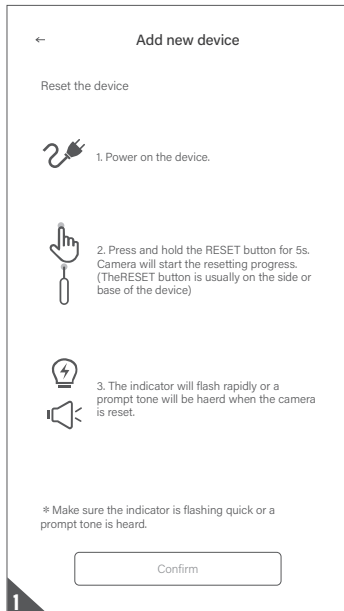

● OPERATION INTERFACE OF Biicam

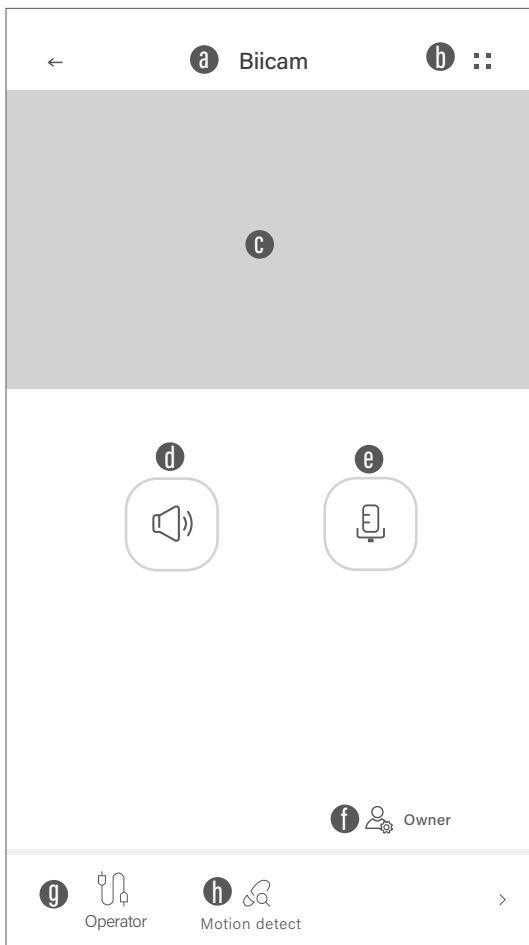

- a Device name
- b Setting page
- c Real-time view
- d Speaker
- e Mic
- f Owner/Manager/User
- g Recorded Videos (only with Micro SD card)
- h Motion detection

### D3. OWNER SHARES THE Biicam TO OTHER USERS

1. Please go to the operation page and tap the setting page icon (::)
2. Tap (Device sharing)
3. Tap (Create new group) icon
4. Name your group and determine a time period
5. Add user by entering Eyeopen accounts
6. The group icon will show at the (Device sharing) page



## D4. PUSH NOTIFICATION

1. Press the icon on the upper left corner to enter the account management page.
2. Tap the push notification setting.
3. Turn **ON** the switches of the notification.

 Please go to the settings page of your smartphone. Find Eyeopen and allow the notifications.

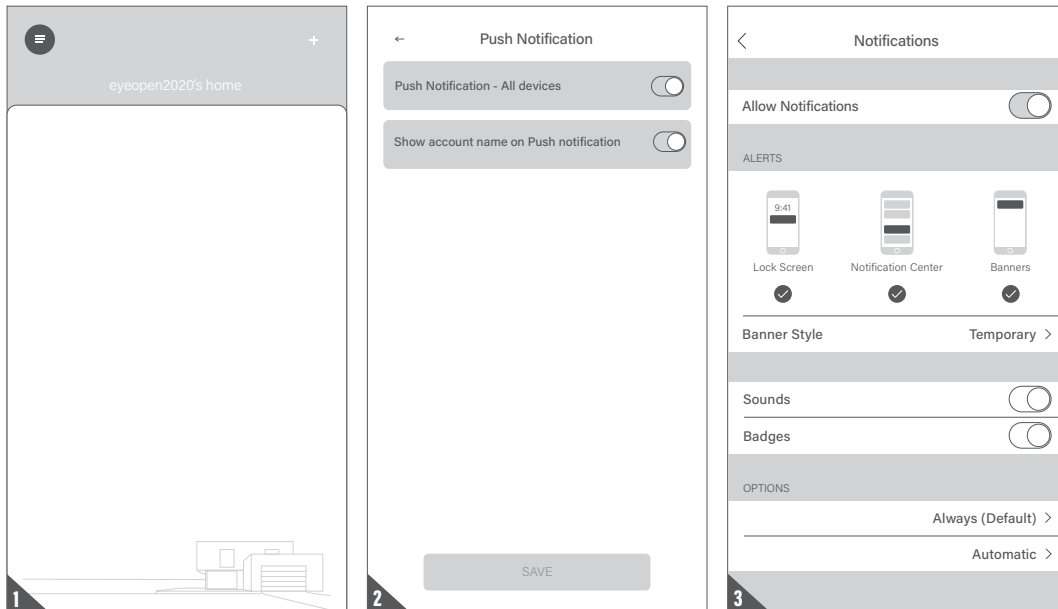

### Question 1

How to reset BO-01 to default setting?

### Answer 1

1. Delete the Biicam on the Eyeopen App by sliding the BO-01 icon and press the delete icon.
2. Press the hard reset button on BO-01 for 10 seconds until it beeps once.

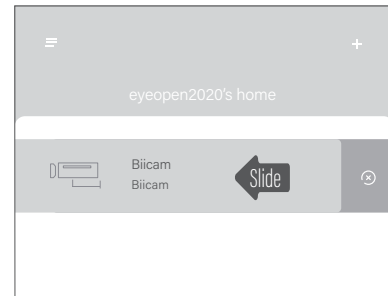

### Question 2

Cannot finish the Wi-Fi connecting countdown.

### Answer 2

1. The system cannot connect with **Non-English SSID/Wi-Fi** network.
2. Make sure the antenna is well connected.
3. Make sure the Wi-Fi signal is strong (above -60dBm).
4. Please connect BO-01 to the Wi-Fi close to your home router.
5. Make sure the Wi-Fi you selected is 2.4GHz.
6. Make sure you entered the Wi-Fi password correctly.

### Question 3

Cannot see the view after BO-01 has already completed the Wi-Fi connection.

### Answer 3

1. Make sure your Wi-Fi is functional.
2. Un-plug and reconnect the power plug of BO-01.
3. Check if you entered the PIN code at the device page.

### Question 4

LED indication

### Answer 4

- Orange light ON – wait until the orange light goes OFF.  
Orange LED and green LED blink alternatively – ready for Wi-Fi connection.  
Green LED ON – BO-01 already connected to Wi-Fi.

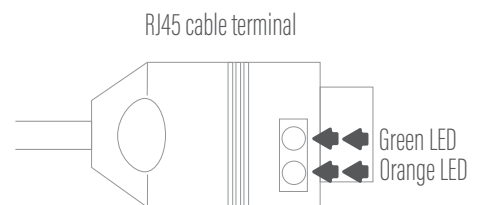

B0-01

